

**CERTIFIED RECORD OF LAND CORNER MONUMENTATION**

INDEX No. G-9

**History of original corner establishment:**

Corner was originally established by Bamford Robb, in Aug, 1880, under General Land Office Contract No. 366. The U.S. Surveyor Generals Notes State: Set stone 16x12x8 in mound of stone, for 1/4 sec. cor.

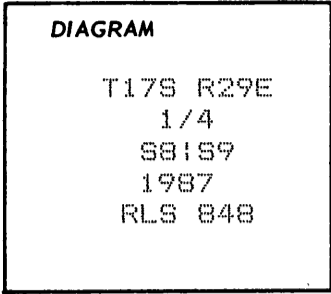

from which:

A pine 40 in. dia. bears N80°E., 89 lks. dist.

**Description of corner evidence found:**

Search area falls Southeast from a primitive road no trace of the original stone or stone mound.

Found a 46" Pine stump, low cut, no marks visible which would fit search area and an old part of a root cluster which would fit the search area, but no conclusive evidence, therefore set the corner at proportionate measure between the section corner found 1/2 mi. North and the section corner as established at proportionate measure, 1/2 mi. South.

**Description of monument and accessories I established to perpetuate the original location of this corner**

Set 2-1/2"x30" aluminum pipe with 3-1/2" aluminum cap, stamped as shown on the **DIAGRAM**, SET 26" in the ground.

From Which:

A Pine 18" dia., Bears N22°W., 33.9 ft., scribed: 1/4 S8 BT  
A Pine 14" dia., Bears S55°E., 6.3 ft., scribed: 1/4 S9 BT  
Measurements to trees taken with a metal tape and magnetic compass, with Declination set off 20 deg. East.  
Nailed a brass washer stamped RLS 848 on blaze above BT scribe, Bearing Tree Sign above blaze, and warning sign on back of each tree. Painted a 6" red band at breast ht. around each tree. Set steel fence post with warning Sign, North 3 ft. from the corner.

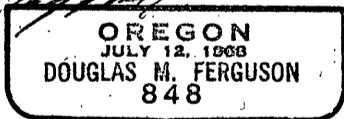
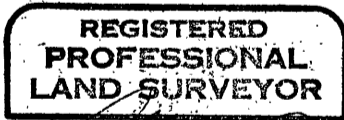

This work is performed by:  
Douglas M. Ferguson RLS 848  
Mt. Vernon Oregon.  
On: June 2, 1987  
Refer to Map of Survey No. 1004

Office of Surveyor County of Grant  
State of Oregon, I hereby certify that the within instrument was filed in this office  
for record on the 2 day of Oct, 1987, at        o'clock        m., (signed)  
       by         
(COUNTY OFFICIAL) (DEPUTY)